

Exam 2

Review

The exam will include 20 Identification, including identification of the New England and Earthfast framing systems, and 2 or 3 essay questions



Parlange, 1750, Pointe Coupee Parish, LA

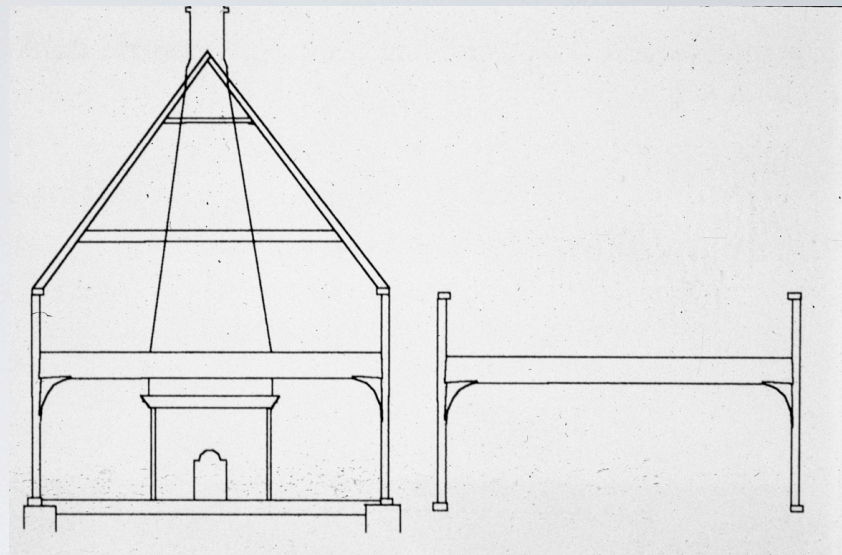

H-Bent or Anchor Balkan Frame of the Dutch House



Luykas Van Alen House, 1737, Kinderhook, NY

French Colonial Framing System

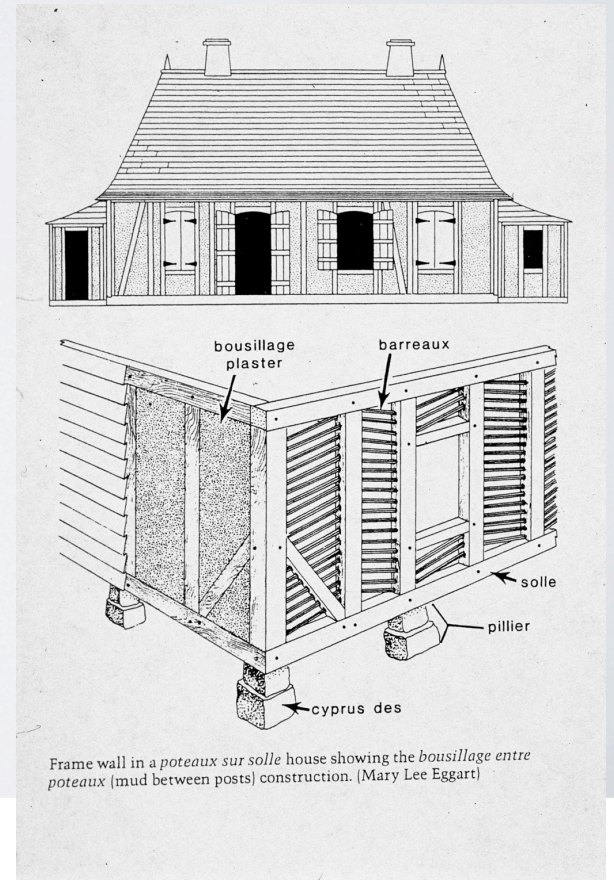



Hans Herr House, 1719, Lancaster, Co., PA

Fachwerk Construction, German
Vernacular

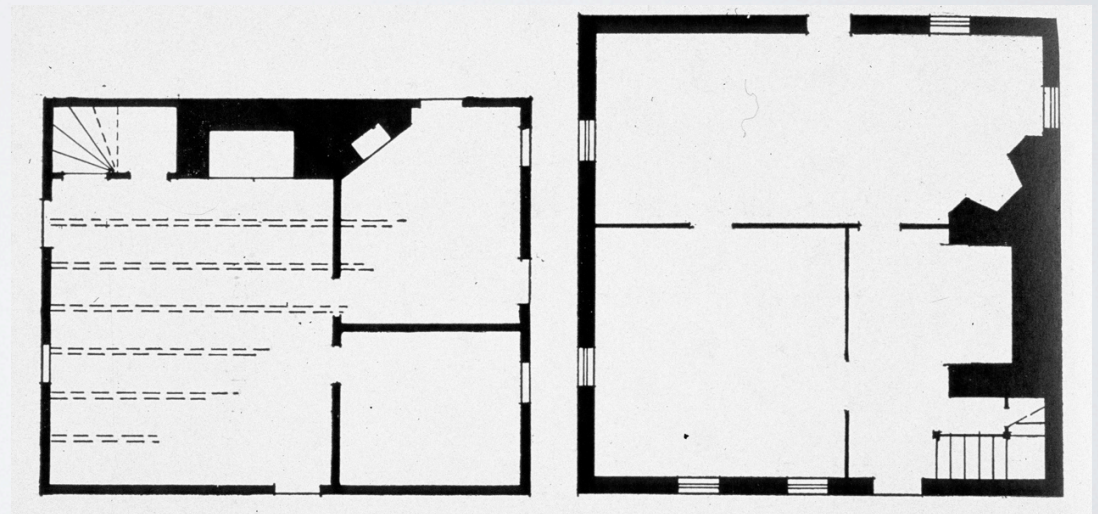

The Penn Plan, suggested by William Penn for settlers in Pennsylvania, and very similar to the German vernacular plan, such as Hans Herr House



Parson Capen House, 1683, Topsfield, MA



Fairbanks House, 1638, Dedham, MA



Plan, New Haven, CT, 1638



Old Ship Meeting House, 1681, Hingham, MA



First Church, 1771, Farmington, CT



First Church, 1816, Lancaster, MA, Charles Bullfinch



Plymouth Meeting House, 1663, Plymouth, MA

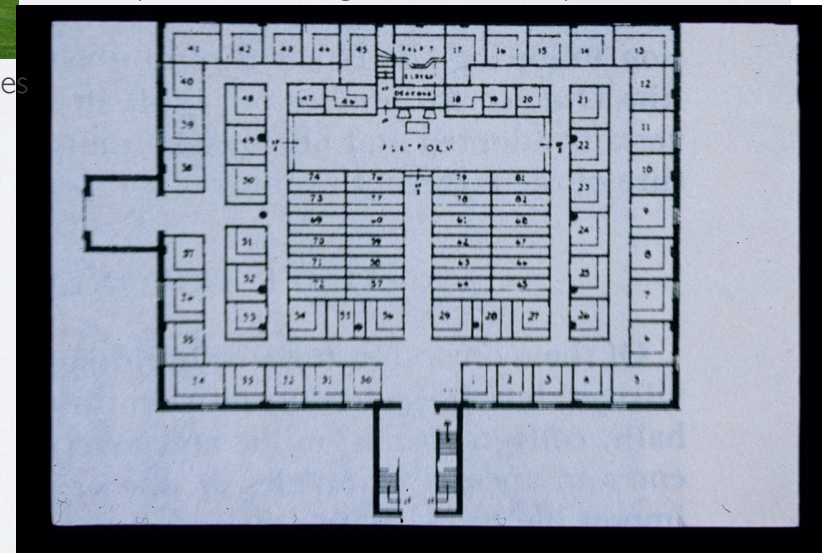

Plan, Old Ship Meeting House, 1681

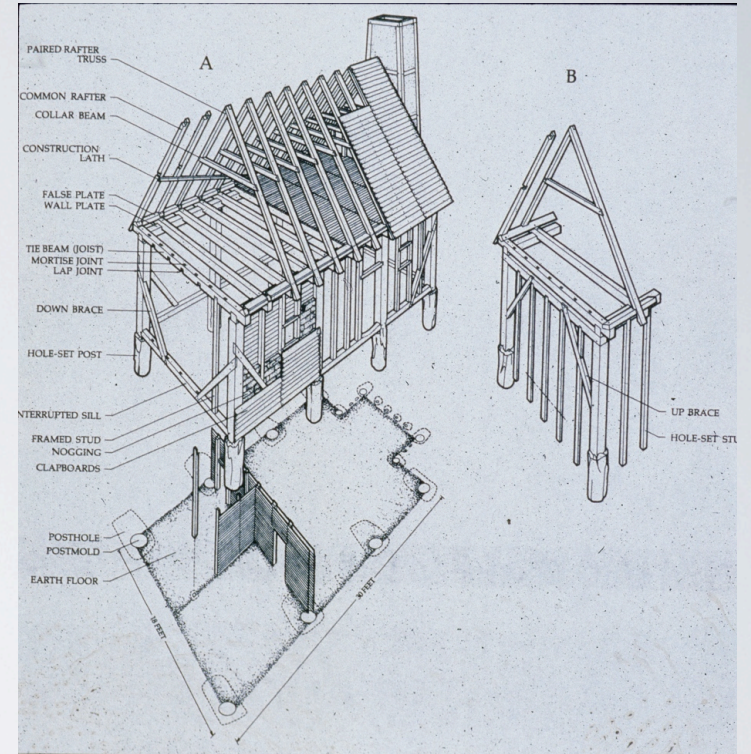
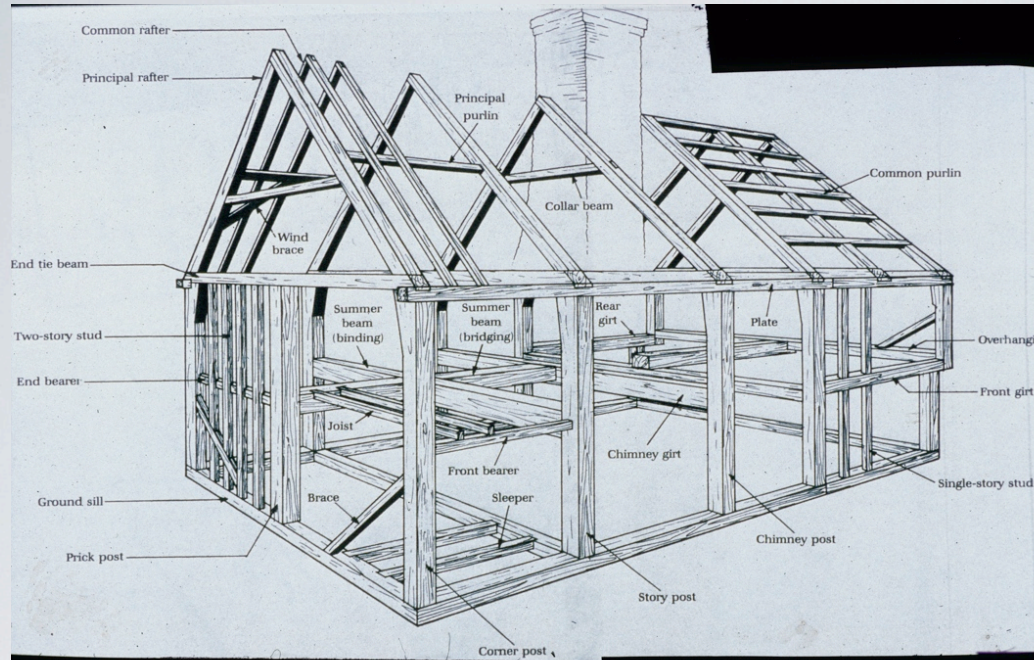

New England Box Frame and Earthfast Frame. Be prepared to name the framing members



Medieval Representations of Zion, the City on a Hill,
and plan of New Haven, 1638



Interior, Christ Church, Lancaster, MA, 1816, Charles Bulfinch



Old Ship Meeting House, Interior, 1681

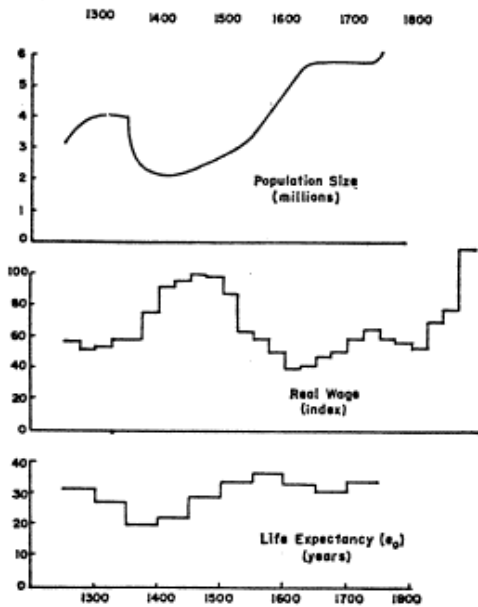

Map A-22

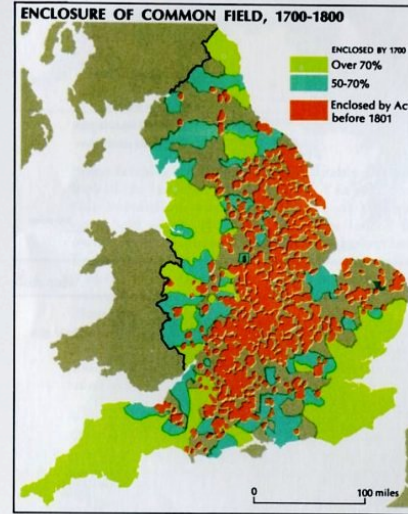

Map A-24

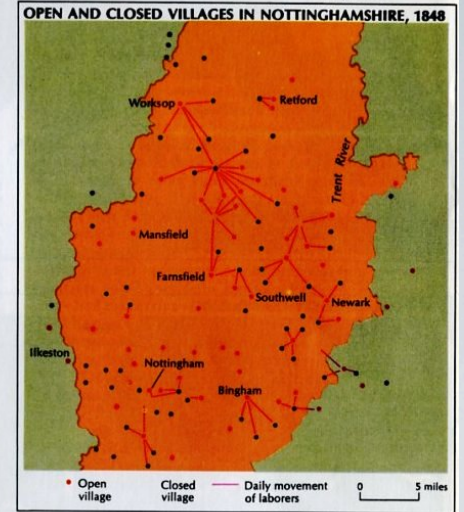

Map A-23

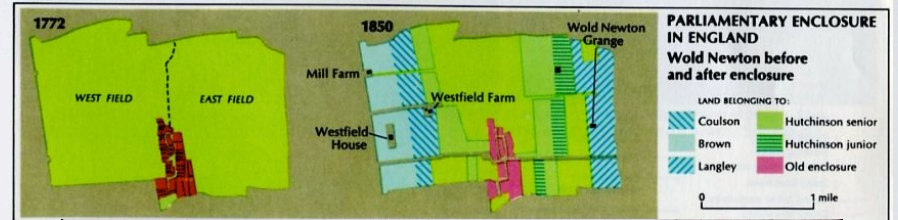

ORIGINS OF MASSACHUSETTS PURITANS

EAST ANGLIA (Norfolk, Suffolk, Essex, Hartford counties)

WEST COUNTRY (Wiltshire, Hampshire, Dorset counties)

YORKSHIRE (Yorkshire, Lincoln counties)

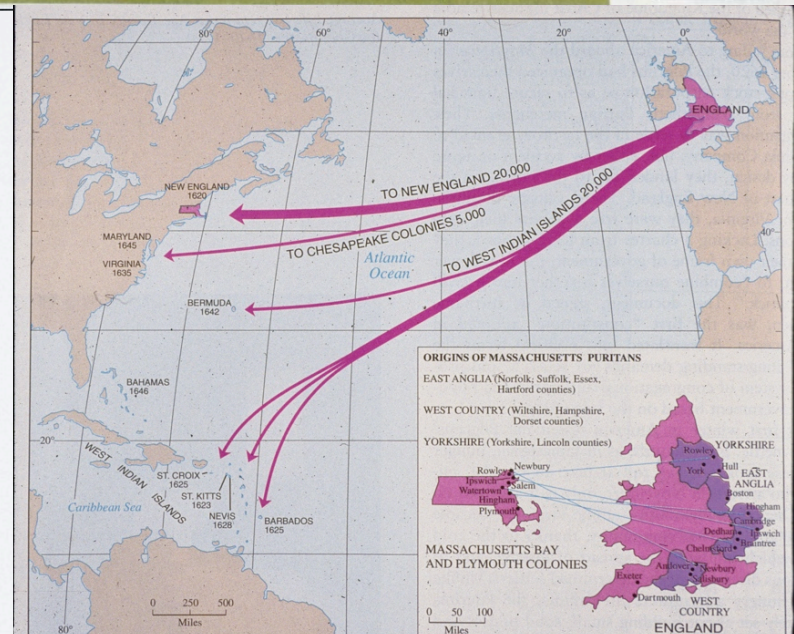
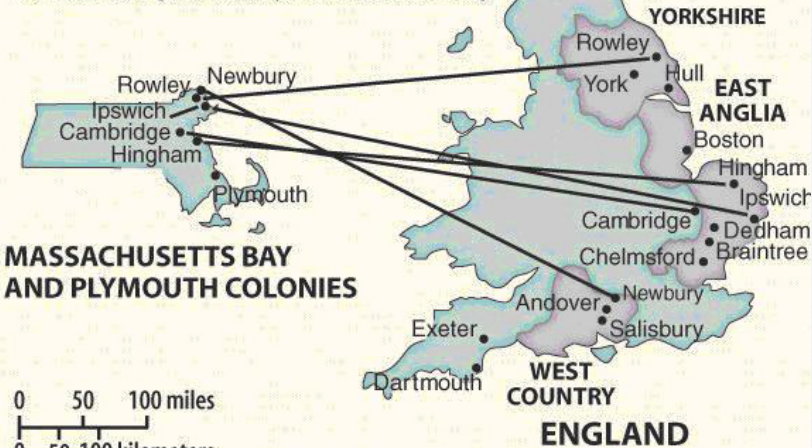

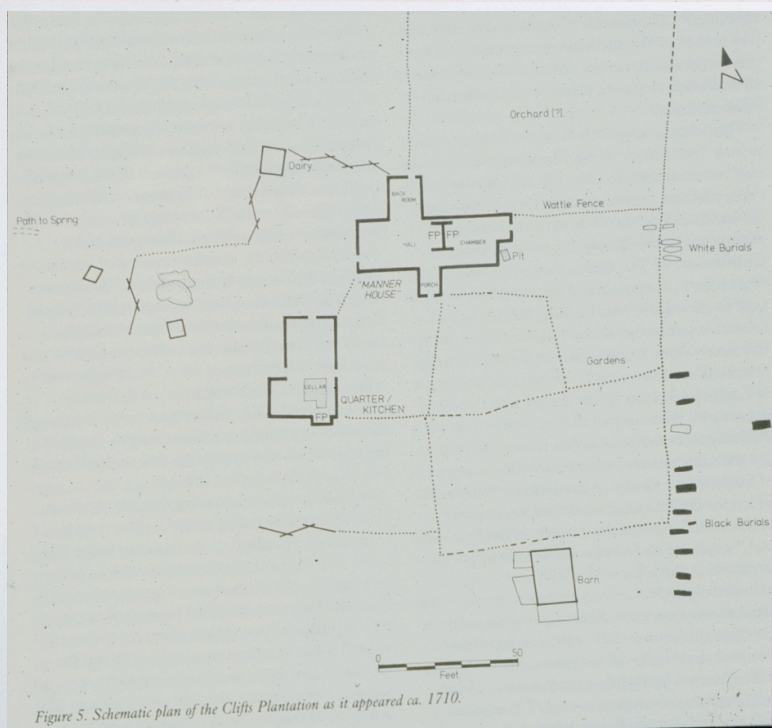
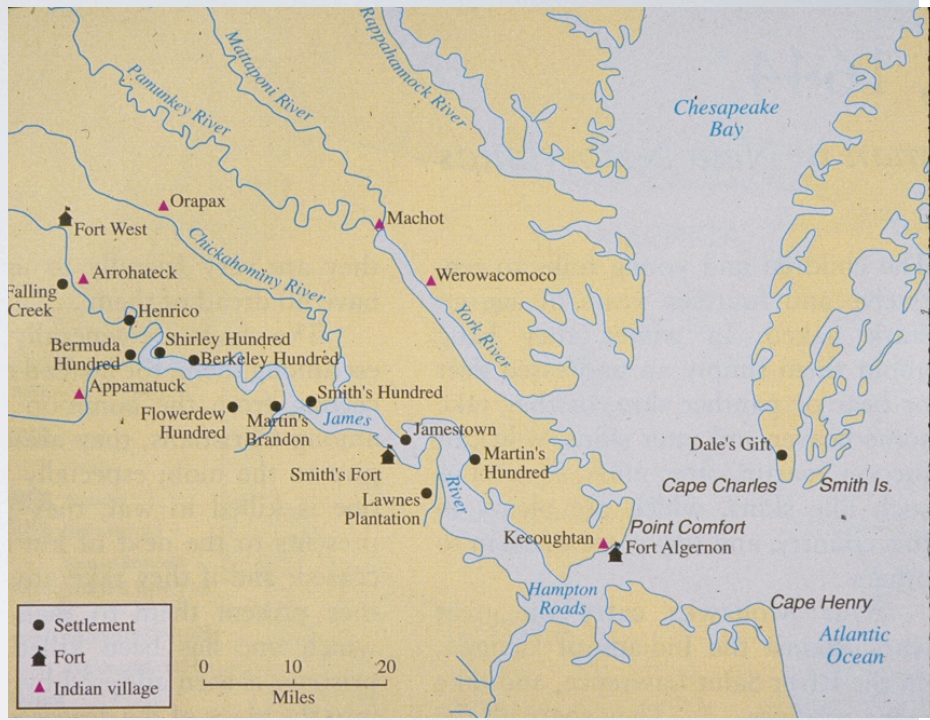
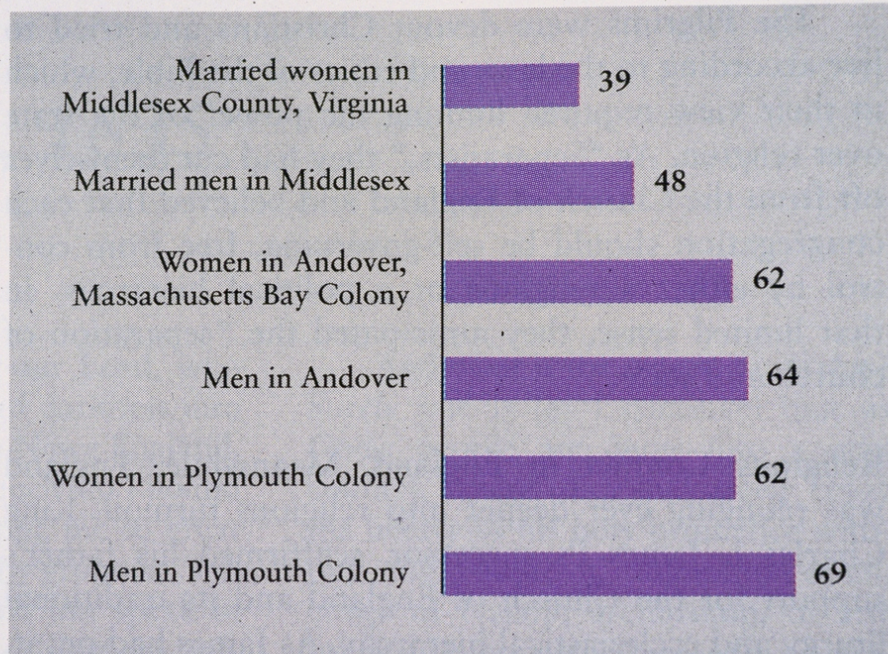
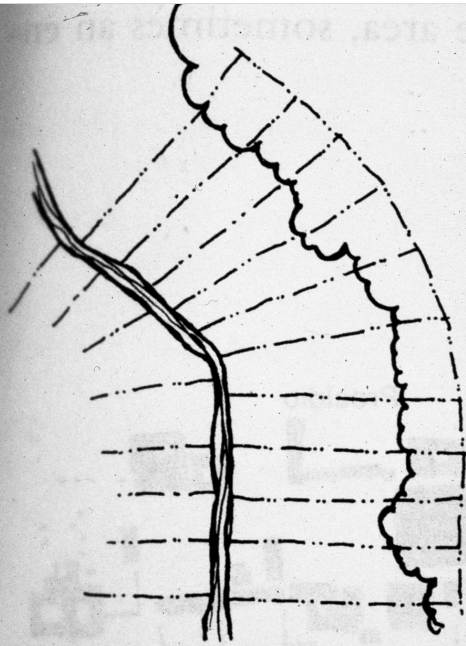

Figure 5. Schematic plan of the Clifts Plantation as it appeared ca. 1710.





Diagrammatic plan of typical long lot pattern along a river.



PITOT HOUSE IS AN EXAMPLE OF WEST INDIES ARCHITECTURE. THIS TYPE OF CONSTRUCTION IS WELL SUITED TO THE CLIMATE OF NEW ORLEANS SINCE LIKE THE WEST INDIES, IS HOT AND HUMID. THE HOUSE IS SUPPORTED BY A MASONRY CHAIN WALL FOUNDATION. THE FIRST LEVEL IS PAVED IN BRICK. THIS FLOORING, THOUGH NOT THE MOST ELEGANT, AIDES IN THE COOLING OF THE HOUSE AND BEARS WELL IN THE ROOMS USED FOR WORK, STORAGE, STORAGE AND DELIVERIES. ALL THE WALLS ON THE FIRST FLOOR ARE OF SOLID MASONRY CONSTRUCTION COVERED WITH STUCCO. THE LARGE COLOSSEAL COLUMNS ON THE FIRST LEVEL ARE ALSO MASONRY CONSTRUCTION COVERED WITH STUCCO. THE PLANKS ON THE SECOND FLOOR ARE OF SOLID MASONRY CONSTRUCTION COVERED WITH STUCCO. THE PLANKS ON THE SECOND FLOOR ARE OF SOLID MASONRY CONSTRUCTION COVERED WITH STUCCO. THE PLANKS ON THE SECOND FLOOR ARE OF SOLID MASONRY CONSTRUCTION COVERED WITH STUCCO. THE PLANKS ON THE SECOND FLOOR ARE OF SOLID MASONRY CONSTRUCTION COVERED WITH STUCCO.

FIGURE 15. COOPER, 1910
 LOCATION: NEW ORLEANS
 ADDRESS: 100 MOISE STREET
 ARCHITECT: J. H. COOPER
 PHOTOGRAPH BY: [unreadable]



French Habitation in the Country of the Illinois.

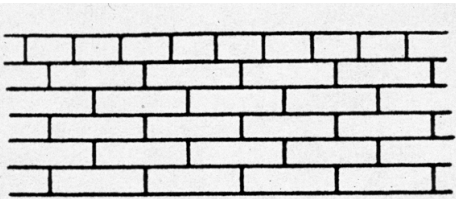

COMMON

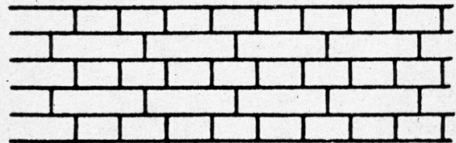

ENGLISH

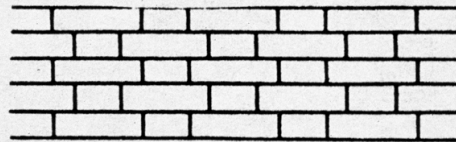

FLEMISH

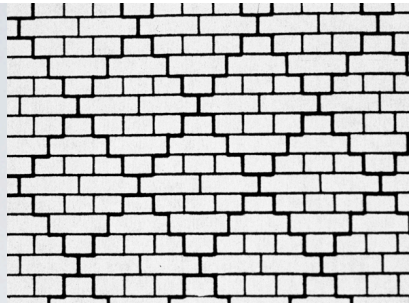

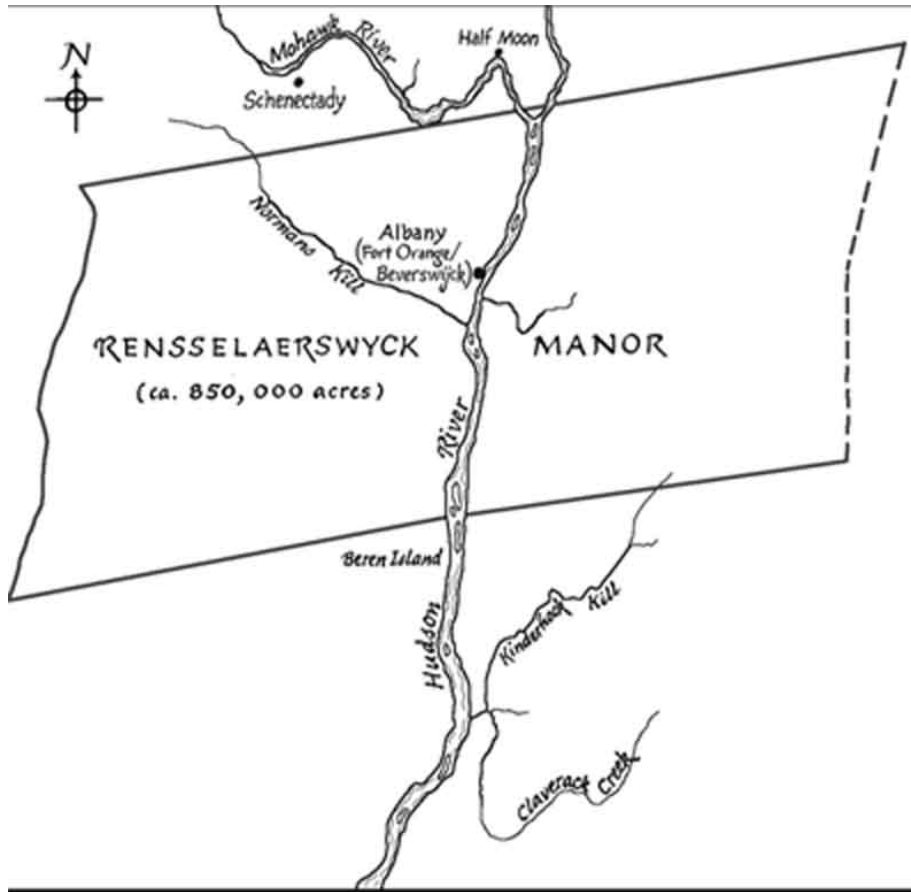

Patroonship, New Netherlands



New Amsterdam

Europe, 1648

Holy Roman Empire

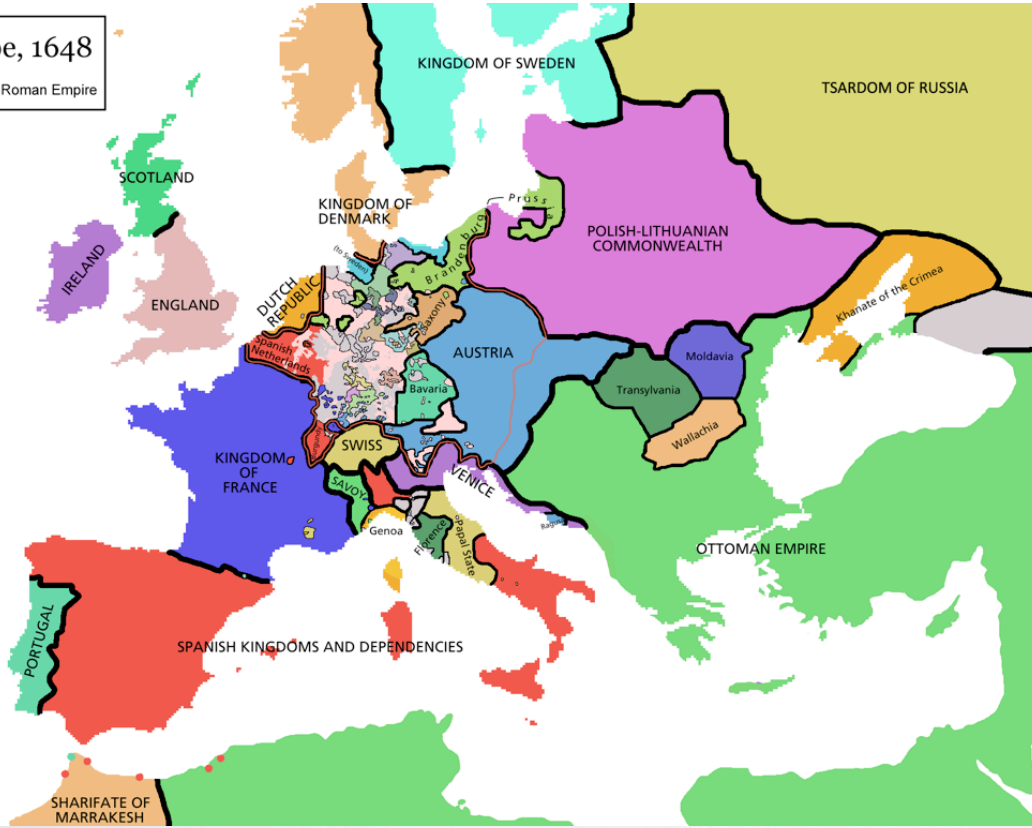

SPANISH NETHERLANDS UNION OF UTRECHT (1579)

